



Call for Applications

Participation in a contest of street art titled “I love the ocean and born to be wild” Marine turtle conservation volunteer programme

This competition will take place during the Ocean week, from the 1st – 8th June 2017, and is to support environmental protection activities that focus on marine turtle conservation – a species that is considered an indicator of the status of the coastal environment. IUCN, with the financial support of the U.S Fish and Wildlife Service, and in collaboration with Ly Son Island District, Ly Son Marine Protected Areas and An Binh commune, have organised a street art contest with the theme “I love the ocean and born to be wild”. The details of the competition are:

I. Objectives

This project encourages professional and non-professional artists to voluntarily participate in the contest and will take place in An Binh commune, on the Small Island (Đảo Bé), Ly Son Island District. The aim of the contest is to raise the awareness of local people and authorities on environmental protection and to convey the message “I love the ocean and born to be wild”.

II. Requirements

1. Main themes of the street art contest include

- The life and livelihoods of local villagers on the island
- Environmental protection of the island
- Marine turtle conservation / Born to be wild

2. Contestants

The call is open for all Vietnamese professional and non-professional artists who have a love of the ocean, islands and the environment.

3. Requirements for artwork

All selected artwork will be created on the wall of some households in An Binh commune, Ly Son Island District (Eg: Georgetown – Penang: <http://www.angloitalianfollowus.com/street-art-in-georgetown-penang>)

The ideas for the artwork will be sent by e-mail to tnvruabien@gmail.com along with artists' profiles; or post on facebook page: [IUCN Vietnam Sea turtle Volunteer group](#) or [IUCN Viet Nam Media Network](#)'s facebook page.

All submitted ideas must not be copied from others. In addition, the artwork must not have been previously published in any newspaper, on the internet or displayed by any means. Artwork already submitted into other contests will not be accepted.

The credit of submitted artwork will belong to both the organisers and the artists. The organisers will be allowed to use artwork in the final round for printing, exhibiting and for communications activities.

Artwork that doesn't follow any of the above rules will be disqualified.

4. Organiser's support for volunteers/artists (*)

- The organisers will arrange locations in some households in An Binh commune, on Small island (Đảo Bé) for selected artists to draw their artwork.
- We will also welcome artists in Ly Son and Đảo Bé.
- Travel expenses to and from Small Island (Đảo Bé) for selected artists will be covered by the organisers.
- Artist will arrange their meals by themselves (they will stay at the households where they draw the paintings. Estimated expenses are around 150,000VND/per person/day).
- Materials for drawing will be arranged by artists.

IV. Organizer

- Implementing agencies: Ly Son Marine Protected Area, An Binh commune
- Coordination agency: IUCN
- Implementation location: An Binh commune, Đảo Bé
- Consultant: artists
- Volunteers
- Local villagers in An Binh island

V. Implementation Timetable

No	Activities	Description	Expected outputs	Responsible by
1	Develop timetable	<ul style="list-style-type: none"> - Develop tentative plan - Consult different partners to get opinions on the plan 	<ul style="list-style-type: none"> - Draft timetable and implementation plan produced 	IUCN (18/2 – 10/3)
2	Set up working group to implement the activities	<ul style="list-style-type: none"> - Call for participation of relevant stakeholders (assign officers in charge to take responsibilities) 	<ul style="list-style-type: none"> - Call for applications of volunteers in Ly Son island 	IUCN (10/3 - 25/3)
3	Initial Survey	<ul style="list-style-type: none"> - Set up working groups, including: <ul style="list-style-type: none"> ▪ An Binh Commune People's Committee ▪ Lý Sơn Marine Protected Area ▪ Donor ▪ Consultant agencies ▪ Volunteers - Conduct surveys on the locations, images, and the size of paintings 	<ul style="list-style-type: none"> - Consensus from local authorities and households participating in the programme is made - Take photos and maps of locations for painting (Đảo Bé) are taken 	Ly Son Marine Protected Area IUCN (26/3 – 5/4)
4	Implementation	<ul style="list-style-type: none"> - Call for the participation of volunteers (artists) to send their ideas of street art to organisers based on the three themes of the programme 	<ul style="list-style-type: none"> - Street art ideas are e-mailed to the organiser 	IUCN (7/4 – 7/5)
5	Selection	<ul style="list-style-type: none"> - Organisers will select good ideas for paintings 		Organisers and consultants (8/5)

		and inform selected artists		– 15/5)
6	Start the paintings	- Start drawing the selected paintings with the participation of local communities, artists and consultants	Ly Son Marine Protected Area and An Binh commune will provide lodging for volunteers. They will have to cover their meals by themselves	Volunteers (1/6 - 8/6)

VI. Submission deadline

Time: 12.00 p.m on 2 May 2017 (via e-mail to e-mail: tnvruabien@gmail.com;

or post on facebook page: <https://www.facebook.com/IUCN-Vietnam-Sea-turtle-Volunteer-group-1623607321258795/> or IUCN Viet Nam Media Network facebook page: https://www.facebook.com/groups/557105371033183/?ref=br_rs&hc_ref=SEARCH

Time to draw at the site: 01- 08 June 2017

(*) Note:

(1) For more information about *Đảo Bé*, please visit:

<http://news.zing.vn/dao-be-hon-ngoc-cua-ly-son-post657445.html>;

<http://ngoisao.net/tin-tuc/thu-gian/an-choi/dao-be-ly-son-noi-ban-muon-den-khong-chi-mot-lan-2936285.html>;

(2) An Binh commune has total square areas of 69,4 ha with the population of 510 people/106 households. The livelihoods of local villagers are fishing and planting onions. Currently, there are 3 fishing boats and 34 small coracles. The rest of local villagers plant onions, garlics and implement eco-tourism activities.

(3) 7 images about the size of the walls where the street art will be drawn and the map of households' location are listed below. The rest 3 images will be updated later.

1. Household *Bùi Thị Quyển* (5 x 2,5 m)



2. Household *Lê Lớn* (3 x4 m)



3. Household *Lê Phước* (7 x 3 m)



4. Household Nguyễn Hữu Phước (3 x 2m)



5. Household Phù Thị Lệ (4 x 2,5 m)



6. Household Trần Sơn (4 x 3 m)



7. Household Trần Thị Thịnh (5 x 3 m)



Map of households' location

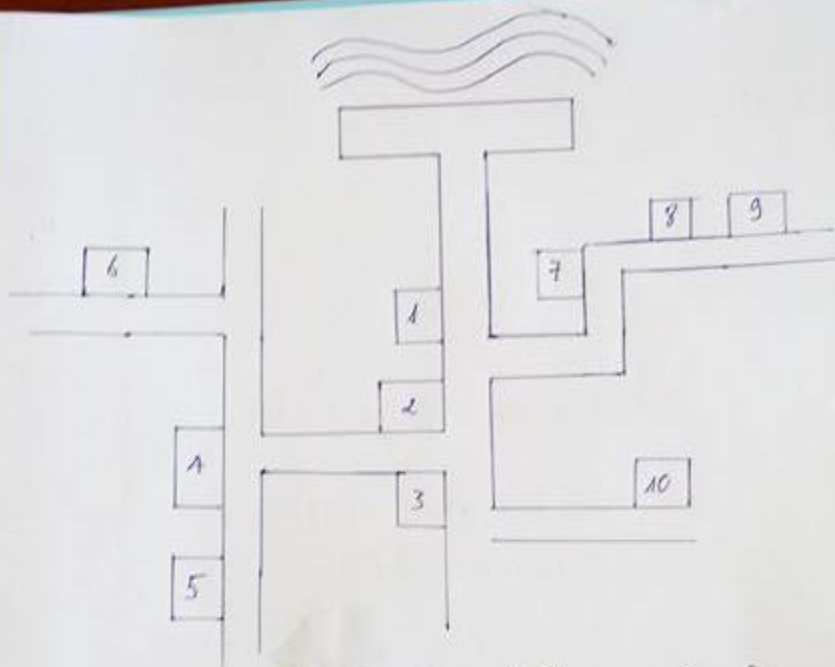

SƠ ĐỒ HỘ DÂN ĐĂNG KÝ VẼ TRANH LÊN TƯỜNG NHÀ
TẠI XÃ AN BÌNH.

- | | |
|---|--|
| 1. Hộ ông Lê Đại : $4^m \times 3^m$ | 6. Hộ ông Nguyễn Đức : $4^m \times 2,5$ |
| 2. Hộ bà Bùi Thị Duyên : $5^m \times 2,5^m$ | 7. Hộ bà Phạm Thị Lệ : $4^m \times 2,5$ |
| 3. Hộ bà Trần Thị Thuần : $5^m \times 3^m$ | 8. Hộ Võ Đình Cường : $2,5^m \times 2^m$ |
| 4. Hộ ông Lê Phước : $7^m \times 3^m$ | 9. Hộ Trần Sơn : $4^m \times 3^m$ |
| 5. Hộ ông Lê Lân : $4^m \times 3^m$ | 10. Hộ Nguyễn Hòa Phước : $3^m \times 2^m$. |